



# Quick Reference for the 4-Port PoweredUSB 2.0 Hub with External Power Supply and Dell Integrator Kit

010776

## Installation information

The USB Driver for this Hub is included in the Windows 2000 operating system. For correct initial enumeration, plug an HID-compliant mouse into the lower USB portion of one port prior to plugging the hub into the Host PC.

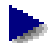
 Windows XP Service Pack 2 includes the updated drivers for this Hub. You can download the *Operations Guide for the 4-Port PoweredUSB 2.0 Hub*, which includes information on the Windows XP setup, from the following Product Support page:

<http://www.cyberdata.net/support/4port20hub/>

## Product components list

- (1) CyberData 4-Port PoweredUSB 2.0 Hub
- (1) Accessory Kit:
  - (1) Dell Retail Integrator Bracket and mounting screws
  - (1) Dell Integrator Twist Lock
  - (1) Short USB 2.0 Hi-Speed host cable
  - (1) Host USB cable strain relief clamp
  - (1) Hub External Power supply
  - (1) *Quick Reference for the PoweredUSB 2.0 Hub with External Power Supply and Dell Integrator Kit*

## Contact CyberData

- 4 Port PoweredUSB 2.0 Hub Product Support URL:  
<http://www.cyberdata.net/support/4port20hub/>
- CyberData Sales URL for cables and connectors:  
<http://www.cyberdata.net/products/powerusb/pusbables.html>
- Phone: (831) 373-2601, Technical Support Ext. 333 or [support@cyberdata.net](mailto:support@cyberdata.net)
- Corporate Web Site URL: [www.cyberdata.net](http://www.cyberdata.net)
- Fax: (831) 373-4193
- Address: 2555 Garden Road, Monterey, CA 93940
- Service, warranty, and Return Materials Authorizations (RMAs): (831) 373-2601 Ext. 136

**Figure 1: Dell Retail Integrator installation**

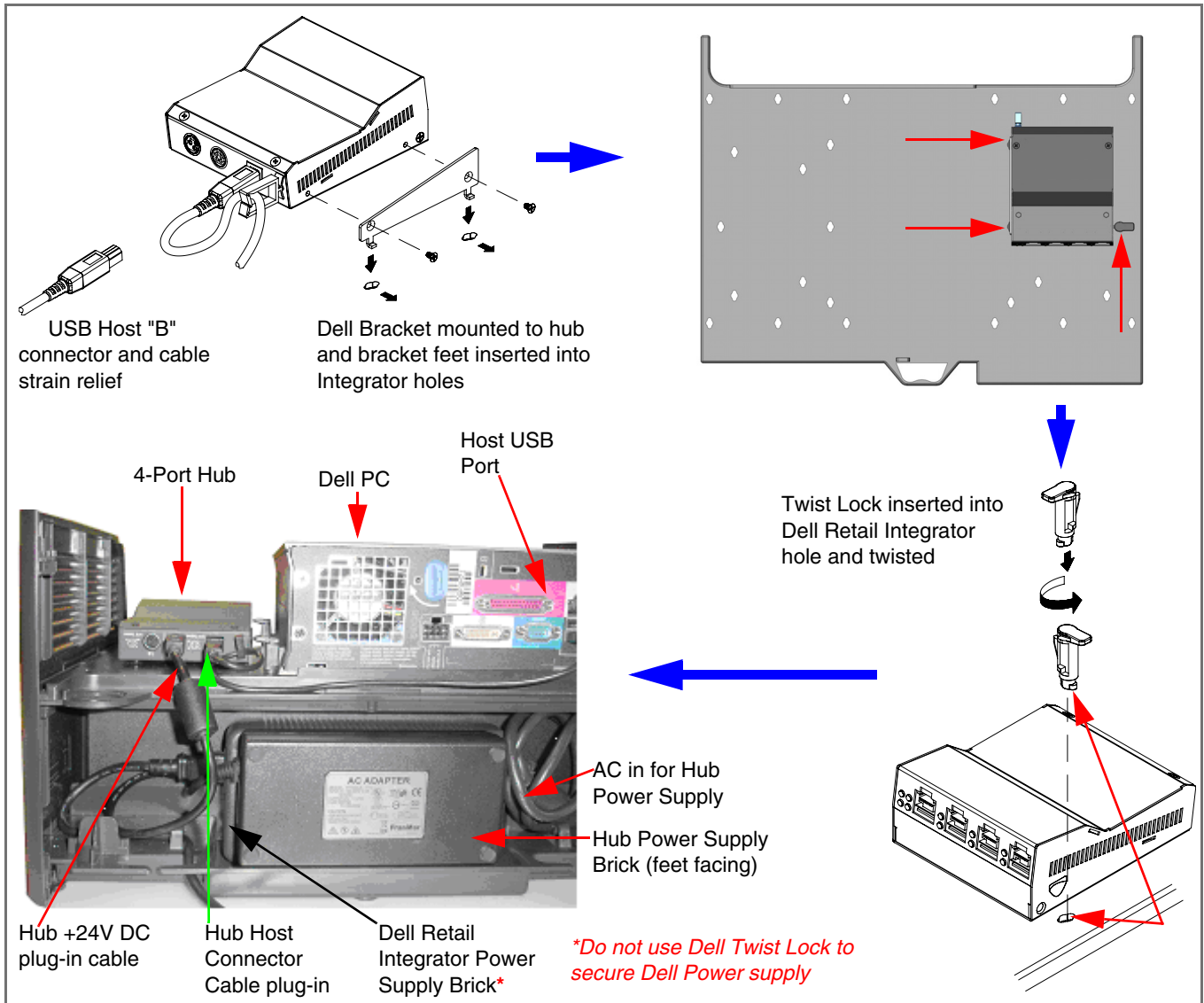

**Figure 2: Component identification: external front and back views**

