

SIP Compliant

011098*, RAL 9002, Gray White, Standard

011099, RAL 9003, Signal White, Optional

*Replaces the 011021 number.



Parameter	Factory Default Setting
IP Addressing	DHCP
IP Address ^a	10.10.10.10
Web Access Username	admin
Web Access Password	admin
Subnet Mask ^a	255.0.0.0
Default Gateway ^a	10.0.0.1

a. Default if there is not a DHCP server present.

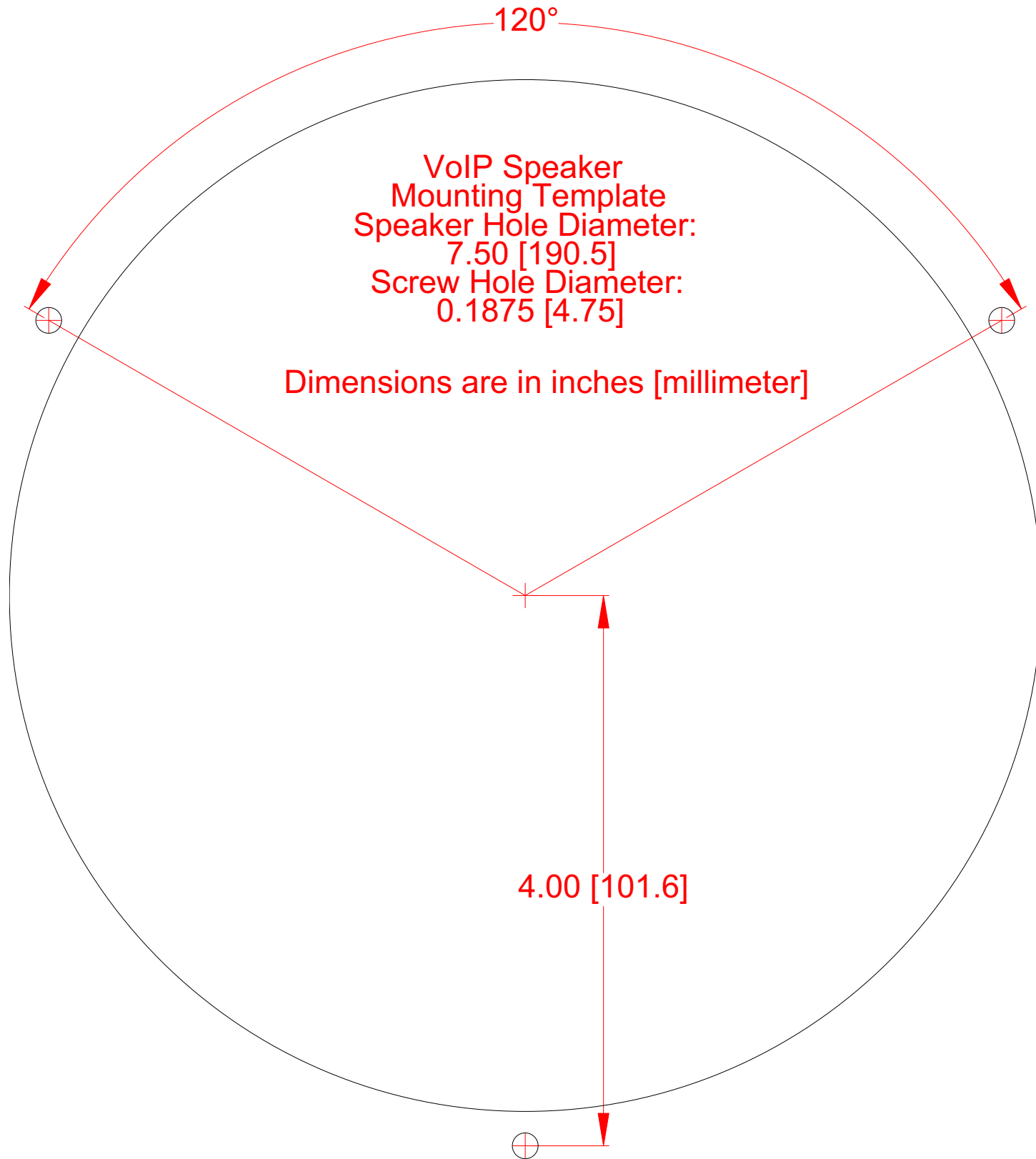

Typical System Installation

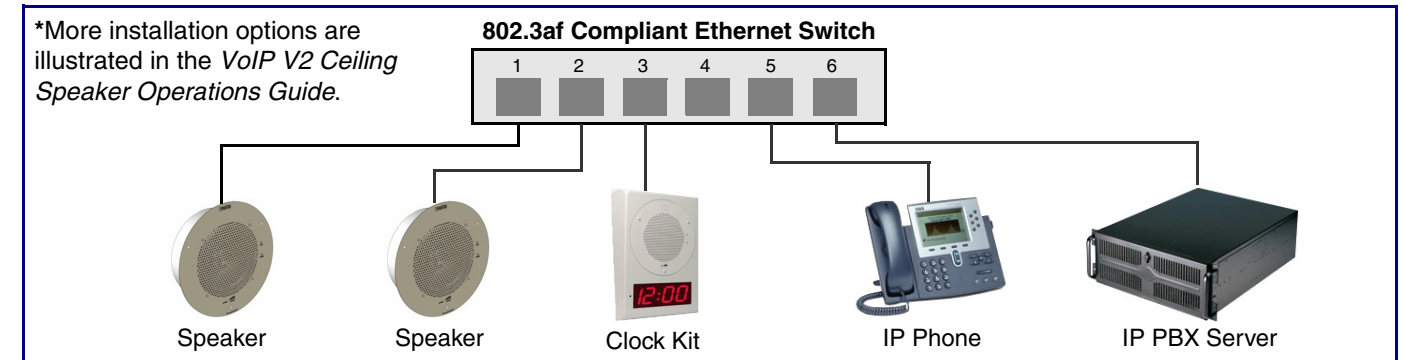

Getting Started

- Download the *VoIP V2 Ceiling Speaker Operations Guide* PDF file from the V2 Speaker **Documentation** page at: <http://www.cyberdata.net/products/voip/digitalanalog/ceilingspkr2/docs.html>
- Create a plan for the locations of your speakers.
- **WARNING:** This product should be installed by a licensed electrician according to all local electrical and building codes.
- **WARNING:** To prevent injury, this apparatus must be securely attached to the floor/wall in accordance with the installation instructions.
- **WARNING:** The PoE connector is intended for intra-building connections only and does not route to the outside plant.
- **WARNING:** The speaker enclosure is not rated for any AC voltages!

Parts

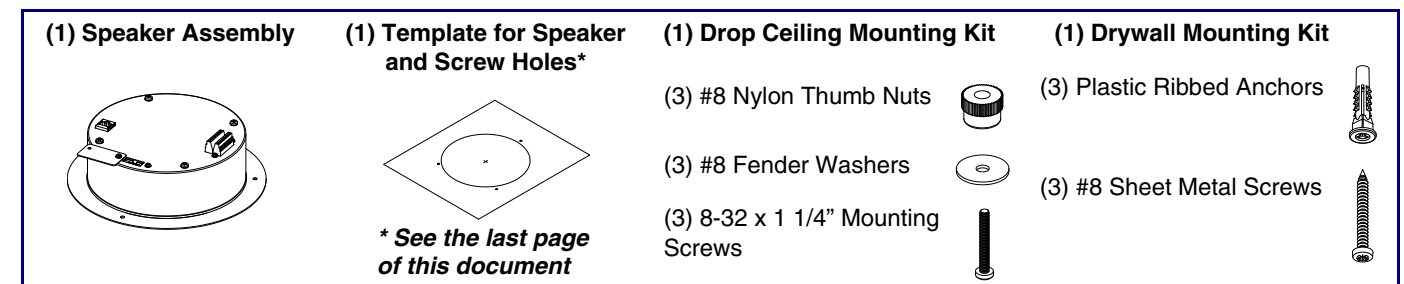

Dimensions and Connections

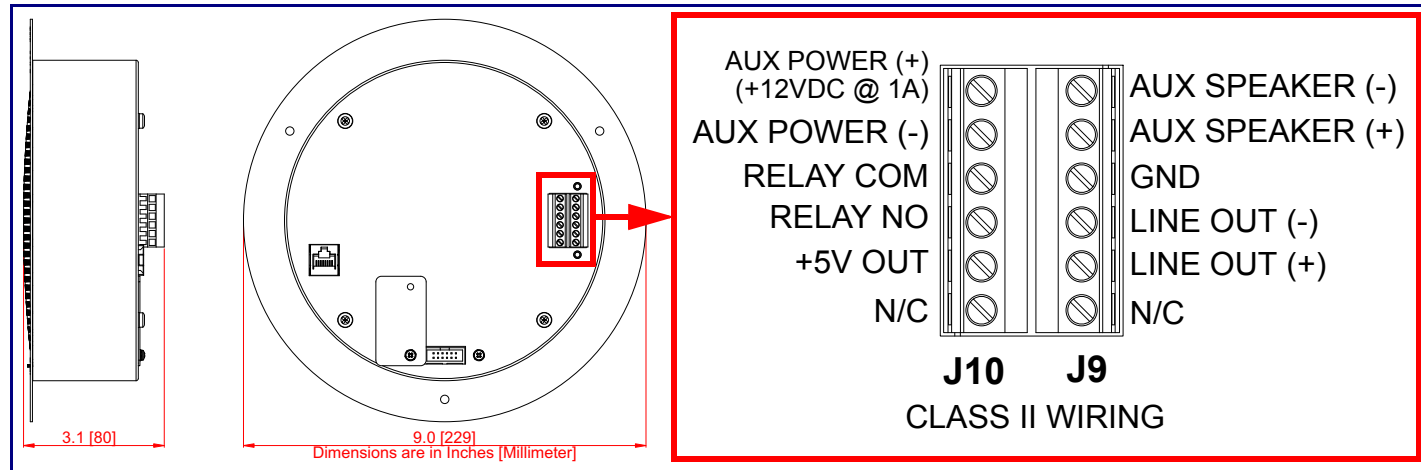

Connecting Power

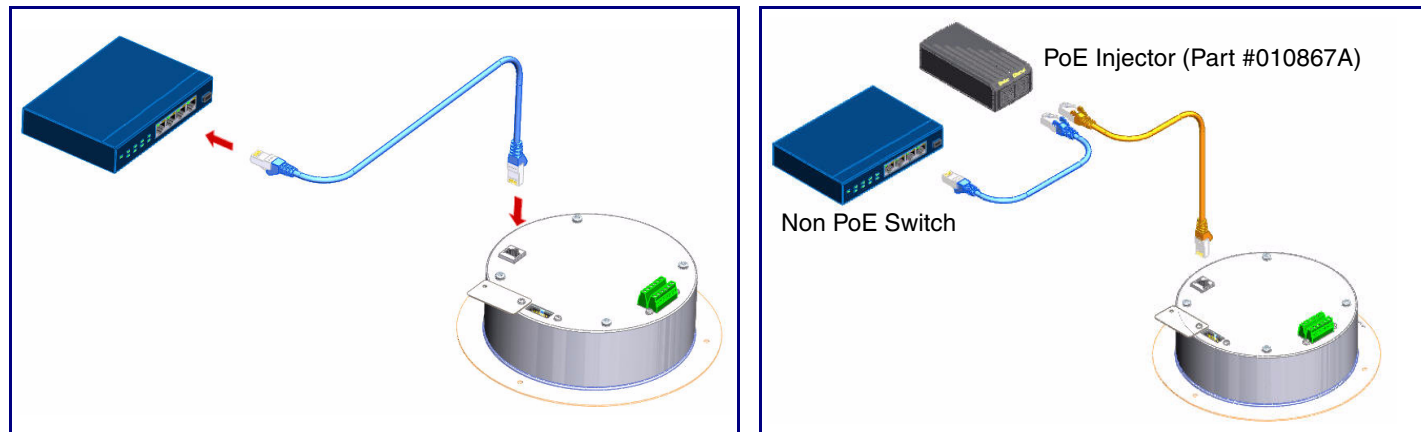

Features

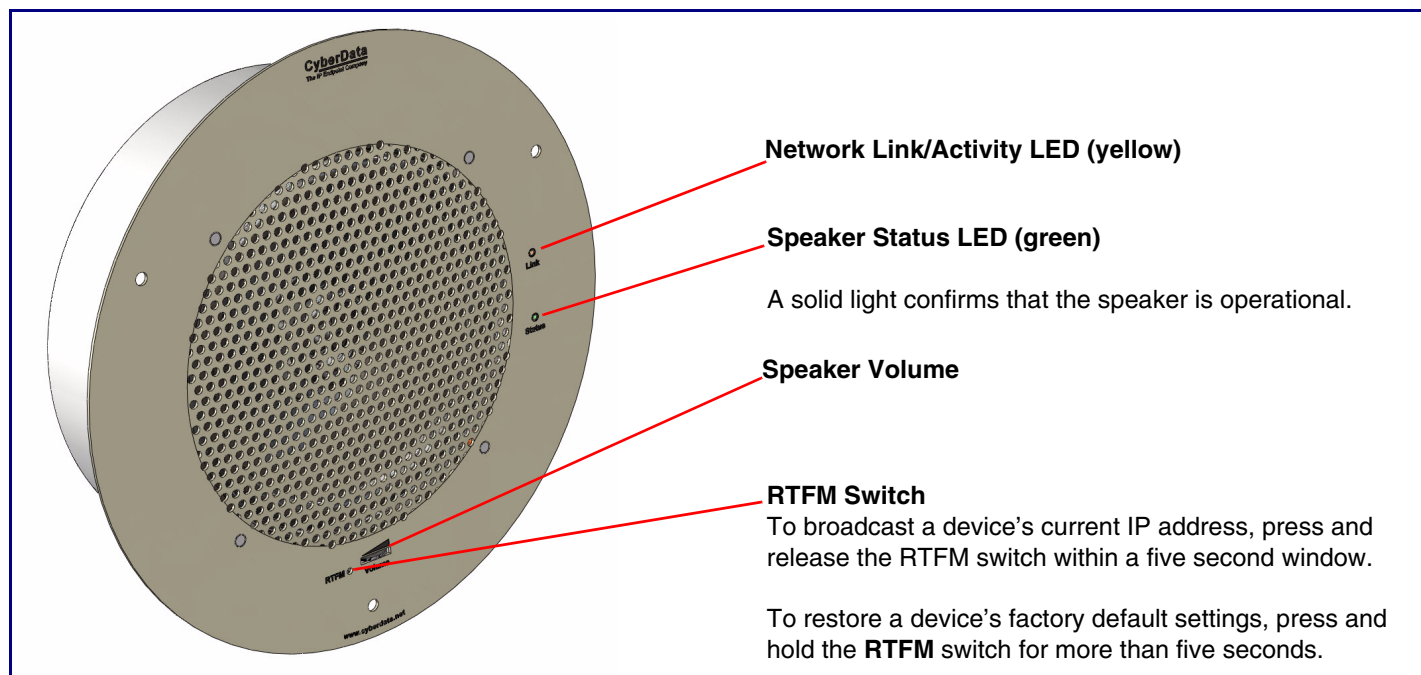

Mounting

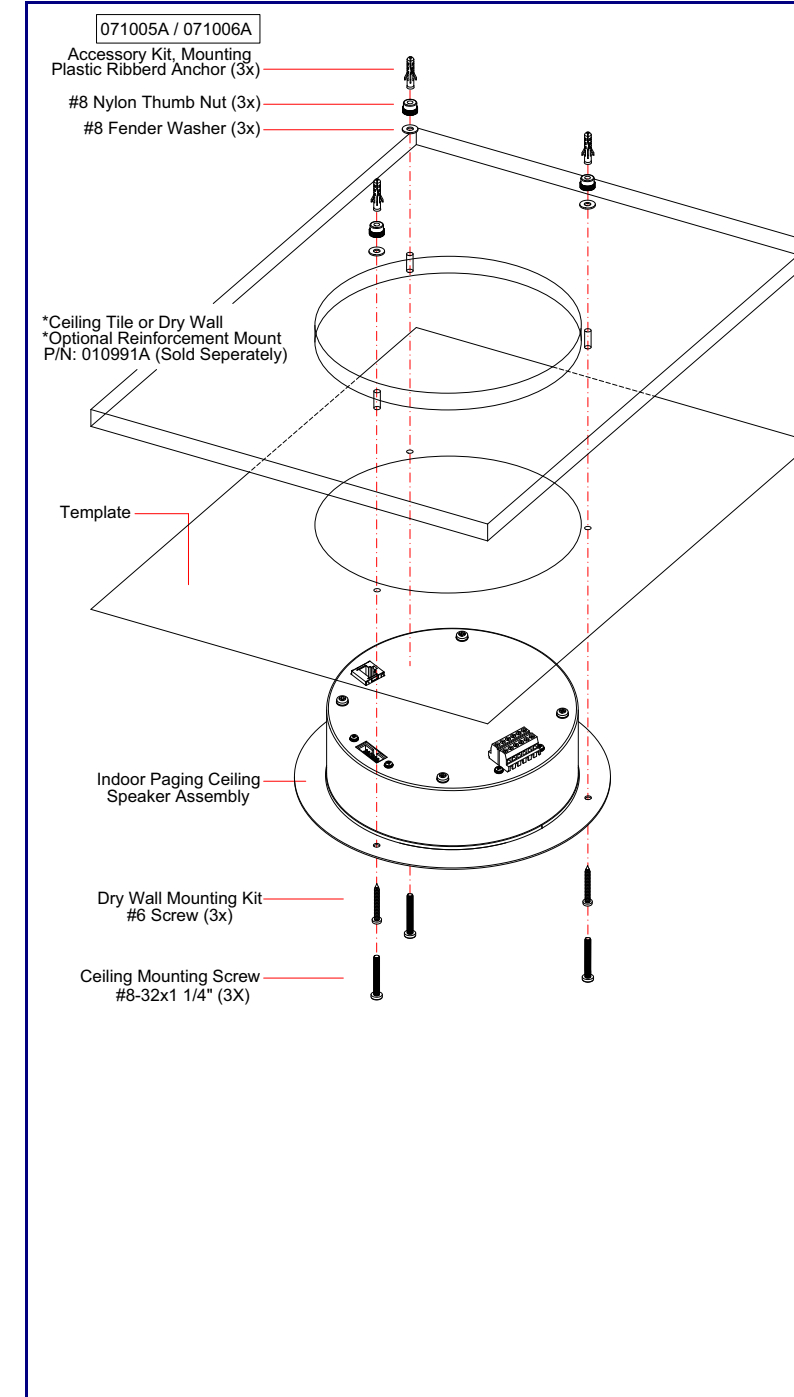

Tools Required for Installation:

- (1) Sheetrock saw or
(1) Drywall cutter
- (1) #2 Phillips Screwdriver or
(1) #2 Phillips Screwdriver Hex Bit

To mount a speaker:

- Use the **TEMPLATE** on the back of this document to cut a hole in the wall or ceiling, and prepare holes for the screws.
- Plug the Ethernet cable into the speaker assembly. The yellow light verifies the network connection.
- For drop ceiling mounting, position the **IP SPEAKER ASSEMBLY** in the ceiling so that its screw holes align with those you prepared.
- For drywall mounting, place the three **PLASTIC RIBBED ANCHORS** in the holes you prepared, and position the **IP SPEAKER ASSEMBLY** over them, aligning the screw holes in the assembly with the anchors.
- For drop ceiling mounting*, use the three **8-32 x 1 1/4" MOUNTING SCREWS**, **#8 NYLON THUMB NUTS**, and **#8 FENDER WASHERS** to secure the speaker.

For drywall mounting, use the three **#8 SHEET METAL SCREWS** to secure the speaker.

* For weak ceiling tile, CyberData offers a reinforcing mount (CyberData part number 010991).

Contacting CyberData

Corporate Headquarters

CyberData Corporation
3 Justin Court
Monterey, CA 93940, USA

Phone: 831-373-2601
Fax: 831-373-4193
<http://www.cyberdata.net/>

Sales: (831) 373-2601 ext. 334
Support: 831-373-2601 ext. 333
Support Website: <http://support.cyberdata.net/>
RMA Department: (831) 373-2601 ext. 136
RMA Email: RMA@CyberData.net
RMA Status: <http://support.cyberdata.net/>
Warranty Information: <http://support.cyberdata.net/>