

Ceiling Tile Drop-In Speaker

Brand New Design

Now available from CyberData is the newest option for installing the CyberData Ceiling Speaker! This new design combines the market leader in IP Speakers--the V2 Ceiling Speakers--with the latest design in speaker mounts. It's streamlined and easy to install, with a 1' x 2' "drop-in" design.

The CyberData SiP-enabled V2 Ceiling Speaker is a Power-over-Ethernet (PoE 802.3af) and Voice-over-IP (VoIP) public address loudspeaker that easily connects into existing local area networks with a single CAT5 cable connection. The speaker is compatible with most SiP-based IP PBX. In a non-SiP environment, the speaker is capable of playing audio from a multicast source.

Ringer Mode

The VoIP V2 Ceiling Speaker supports two SIP extensions. One extension can be assigned to a page group for auto answer paging. The second extension can be assigned to a "First-to-Answer" ring group with IP phones. An audio ring file is activated when the second SIP extension of the ceiling speaker is dialed. If any of the IP phones in the ring group is answered (or if the caller hangs up), the Ceiling Speaker stops ringing.

Features

- SIP (RFC 3261) compatible
- Simultaneous SIP and multicast
- Web-based configuration
- Paging prioritization
- Web-based firmware upgradeable
- Plenum-rated enclosure
- Autoprovisioning
- High efficiency speaker driver
- PoE 802.3af Enabled (Powered-over-Ethernet)
- DTMF-controlled relay
- Line-out connection
- Network speaker volume control
- Can drive one external analog speaker for greater coverage
- User-uploadable ring and alert tones
- RoHS compliant



Specifications

| | |
|-----------------------|----------------------------|
| Sensitivity | 96dB / 1W / 1M S.P. Level |
| Output | 10 Watts Peak Power |
| Operating Temperature | -30 to 55 C (-22 to 131 F) |
| Ethernet I/F | 10/100 Mbps |
| Protocol | SIP RFC 3261 Compatible |
| Power Input | PoE 802.3af |
| Payload Types | G711, A-law and μ -law |

| | |
|--------------------|--------------------------|
| Dimensions (Unit) | 23.75" x 12" x 3.23" |
| Dimensions (Boxed) | 28.25" x 16.25" x 8.125" |

| | |
|--------------|---------|
| Boxed Weight | 8.0 lbs |
|--------------|---------|

| | |
|----------|-----------------|
| Warranty | 2 years limited |
|----------|-----------------|

| | |
|----------------------------|----------------------------|
| Part Numbers | |
| CyberData V2 Speaker | 011128, Color: "Off-White" |
| Singlewire-enabled Speaker | 011199, Color: "Off-White" |
| Syn-Apps-enabled Speaker | 011200, Color: "Off-White" |
| Auxiliary Speaker | 011201, Color: "Off-White" |

Ceiling Tile Drop-In Speaker

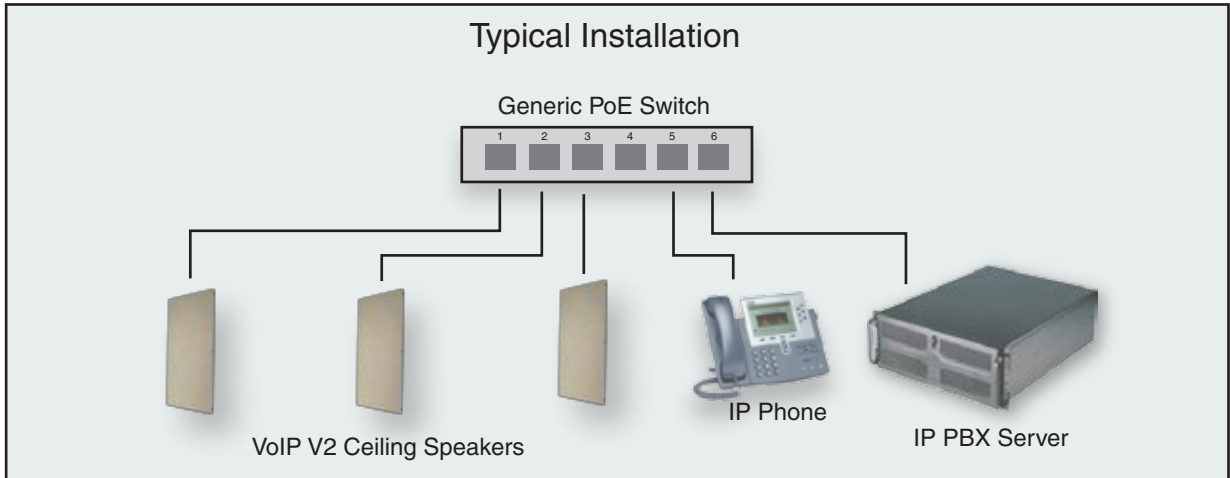

V2 Speaker with Extra Speaker Connection

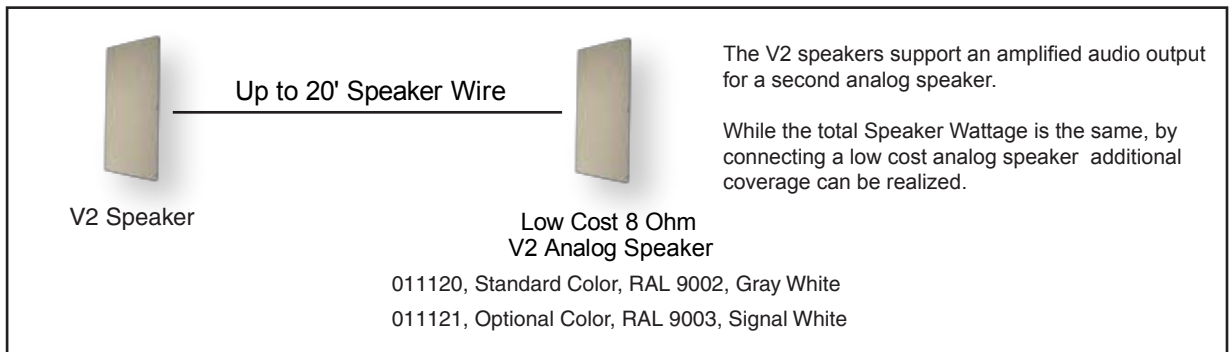

Assembly Exploded View

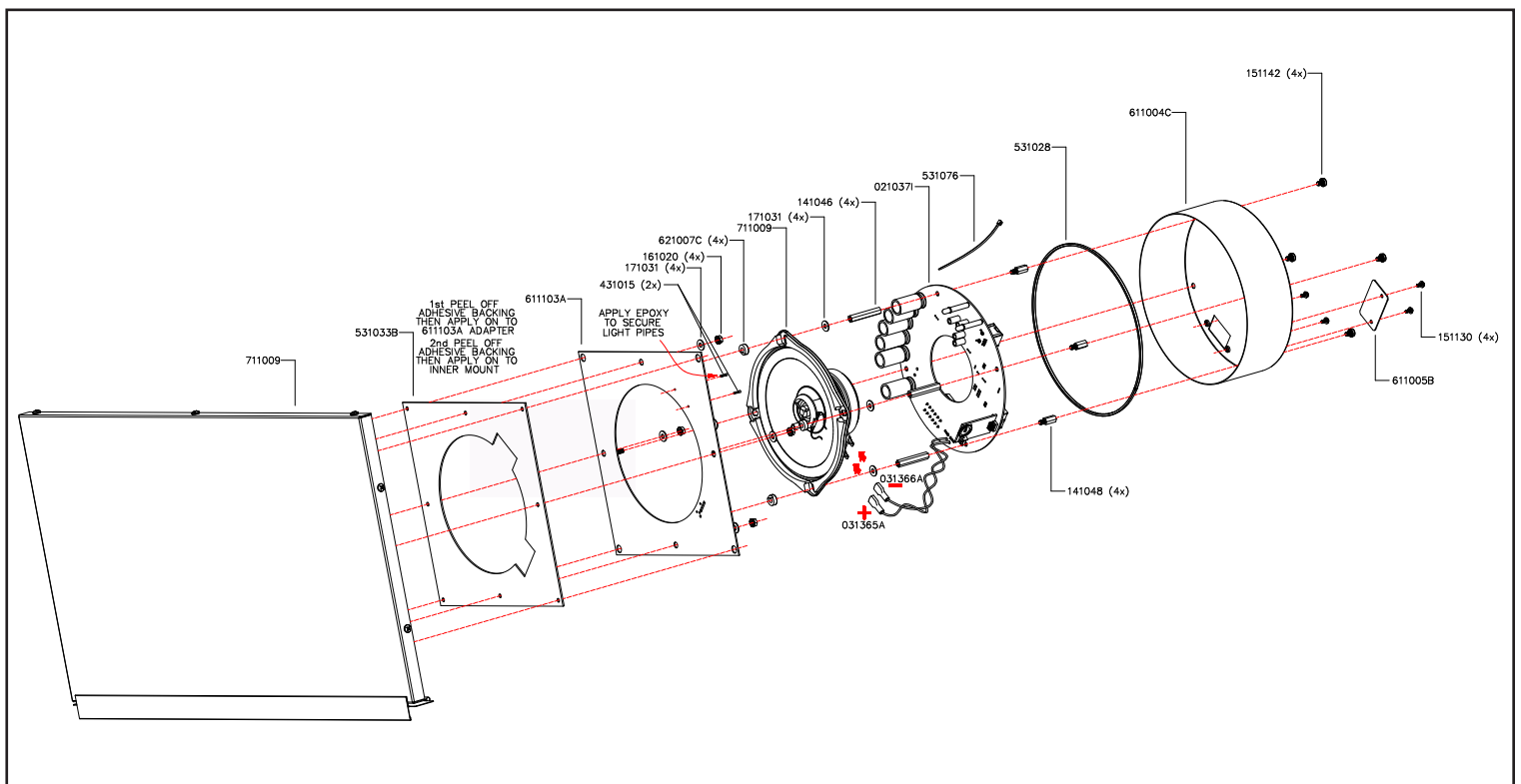

Ceiling Tile Drop-In Speaker

Packaging

