

LED Behavior and RTFM Button Location

Status and Link LEDs (at J1):	
LED Behavior	Means
The AMBER Status LED is on and the GREEN Link LED is on and blinking.	No fault detected. The device is on the network and the device is not active.
Note: On boot, within approximately three seconds, the AMBER Status LED and the GREEN Link LED come on with the GREEN Link LED beginning to blink almost immediately.	
Board LED (DS1):	
LED Behavior	Means
On and solid RED	No fault detected. A relay is not engaged.
On and solid GREEN	No fault detected. A relay is engaged.
One long RED flash and a short RED flash	Device hardware fault, communication error
One long RED flash and one short AMBER flash	Device hardware fault, communication error
One long RED flash and two short AMBER flashes	Device hardware fault, memory error
One long RED flash and three short AMBER flashes	Device hardware fault, fuse
One short RED flash and one short AMBER flash	Network address, DHCP Issue
Note: On boot, the board LED blinks RED once, and then remains on and solid RED until a relay is engaged.	

The diagram shows the internal components of the relay. Red lines point to the **AMBER Link LED**, **GREEN Activity LED**, **RTFM button (SW1)**, and **Board LED (DS1) (RED or GREEN)**. The RTFM button is labeled with a note: "(See the Operations Guide for more information.)". The terminal block on the right is labeled with various pins: COM2, NO2, NC2, N2, COM1, NO1, NC1, N1, +5VDC OUT (500mA), BTN2L, BTN2H, DOOR2L, DOOR2H, BTN1L, BTN1H, DOOR1L, DOOR1H, and SENSE1.

Contacting CyberData

Corporate Headquarters	
CyberData Corporation 3 Justin Court Monterey, CA 93940, USA	Sales: 831-373-2601 ext. 334 Support: 831-373-2601 ext. 333 Support Website: https://support.cyberdata.net/ RMA Department Contact and Status: https://support.cyberdata.net/ Warranty Information: https://support.cyberdata.net/
Phone: 831-373-2601 Fax: 831-373-4193 https://www.cyberdata.net/	

Installation Quick Reference Network Dual Door Strike Relay 011375



Specifications	
Power Input	PoE IEEE 802.3af
Operating temperature	-10° C to 50° C (14° F to 122° F)
Relay Voltage/Current	12 A @ 250 VAC / 12 A @ 24 VDC

 GENERAL ALERT	<p>Warning <i>Electrical Hazard:</i> Hazardous voltages may be present. No user serviceable part inside. Refer to qualified service personnel for connecting or servicing.</p>
-------------------	---

Getting Started

- Download the *Operations Guide* PDF file, from the **Downloads** tab at: <https://www.cyberdata.net/products/011375/>
- WARNING:** This product should be installed by a licensed electrician according to all local electrical and building codes.
- WARNING:** To prevent injury, this apparatus must be securely attached to the floor/wall in accordance with the installation instructions.
- WARNING:** The PoE connector is intended for intra-building connections only and does not route to the outside plant.
- WARNING:** This enclosure is not rated for any AC voltages!

Firmware Version Details

The device is compatible with many CyberData SIP and InformaCast Enabled devices. For a complete list of CyberData devices which are compatible with Network Dual Door Strike Relays, click here.

The device can be configured to pulse for a set amount of time, configured on the web page in seconds, or to activate until de-activated. In AirLock Mode, the activation of the second relay depends upon the activation of the first relay, and the opening and closing of the first door. The Keypad Intercom offers the additional option of activating and deactivating the relay from the keypad.

For the most up to date information, please refer to our website: <http://www.cyberdata.net/products/011375/>

Parts

(1) Network Dual Door Strike Relay 	(3) Pan Head Sheet Metal Screw 	(3) Plastic Ribbed Anchor 	(4) Enclosure Screw
--	------------------------------------	-------------------------------	-------------------------

Dimensions

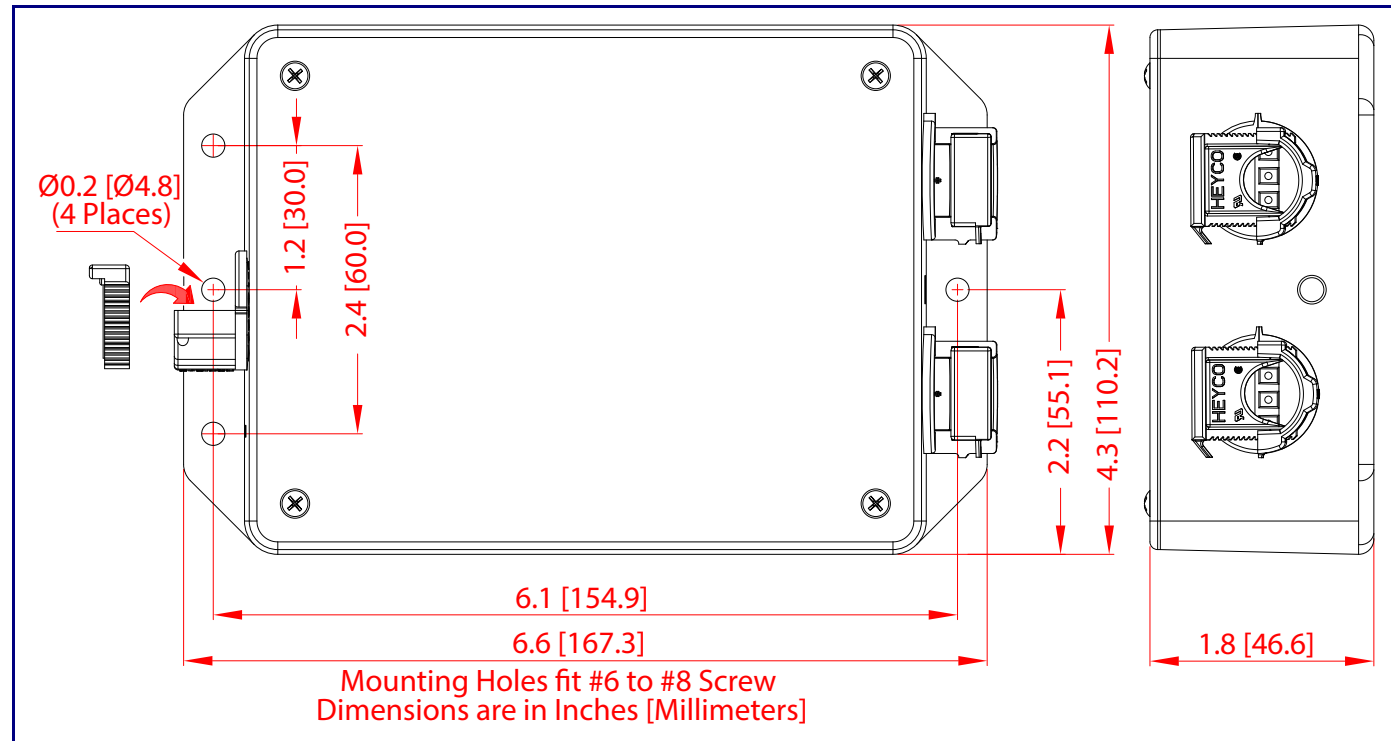

Assembly

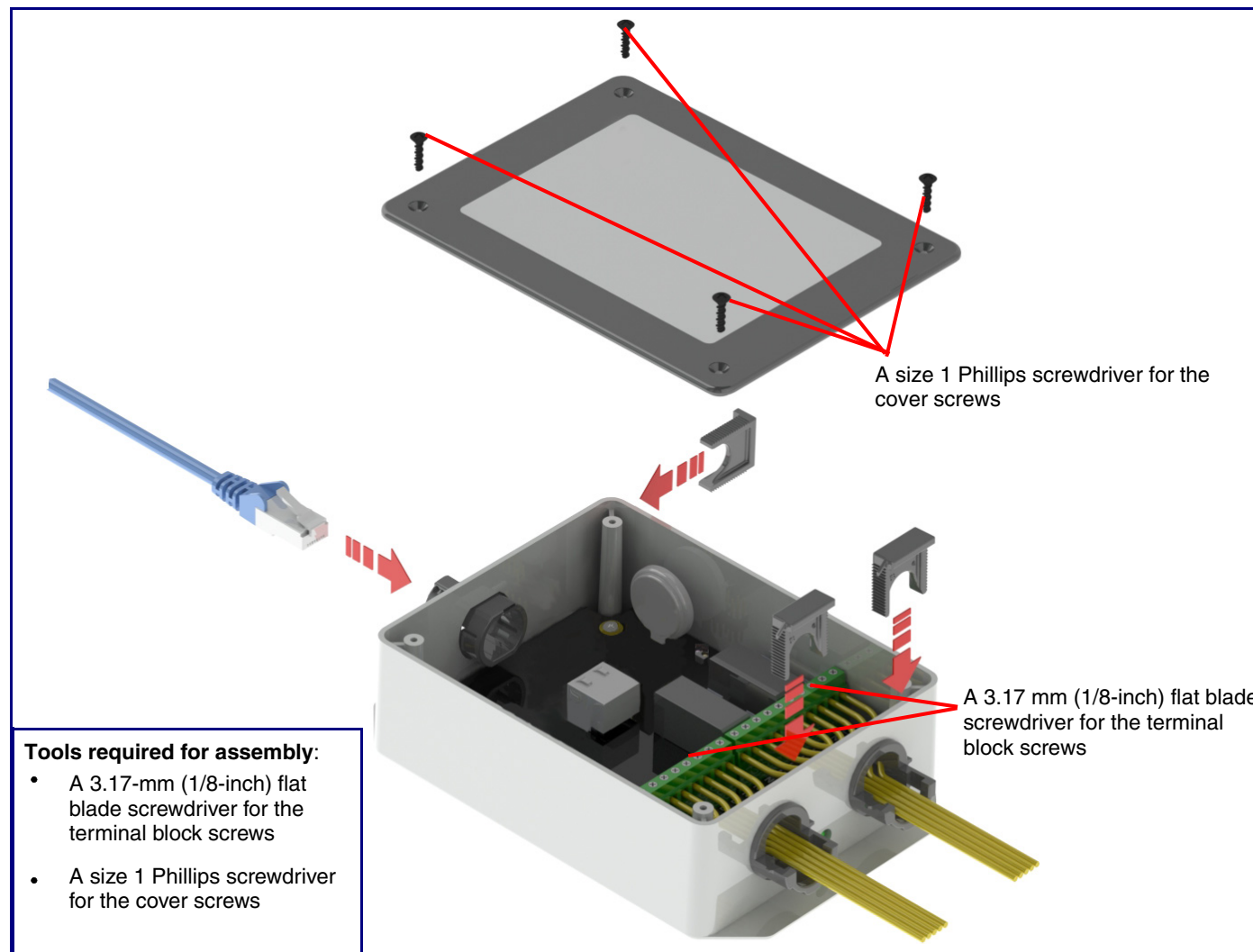

Network Dual Door Strike Relay Wiring Diagram with External Power Source

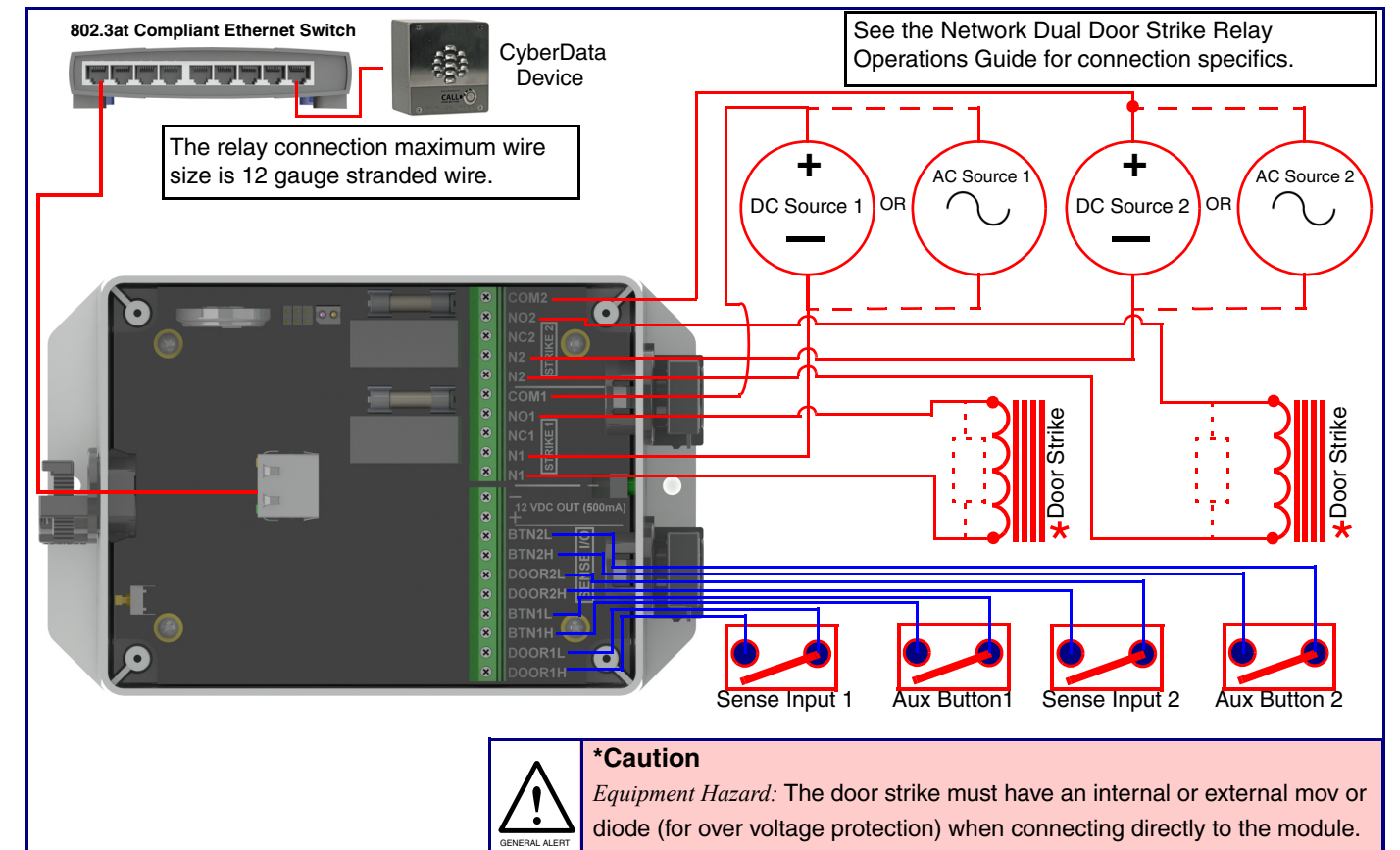

Network Dual Door Strike Relay Wiring Diagram Using PoE+

