

Dimensions are in Inches [Millimeter]

Wall Cutout Diameter: Ø6.7 in. [Ø170 mm]

The wall thickness must not exceed 1.0 in. [25 mm]

CyberData

The IP Endpoint Company

Installation Quick Reference

Multicast Ceiling Speaker

SIP Compliant

011458



Parameter	Factory Default Setting
IP Addressing	DHCP
IP Address ^a	IPv4 Link Local
Web Access Username	admin
Web Access Password	admin
Subnet Mask ^a	IPv4 Link Local
Default Gateway ^a	IPv4 Link Local

a. Default if there is not a DHCP server present.

Typical System Installation

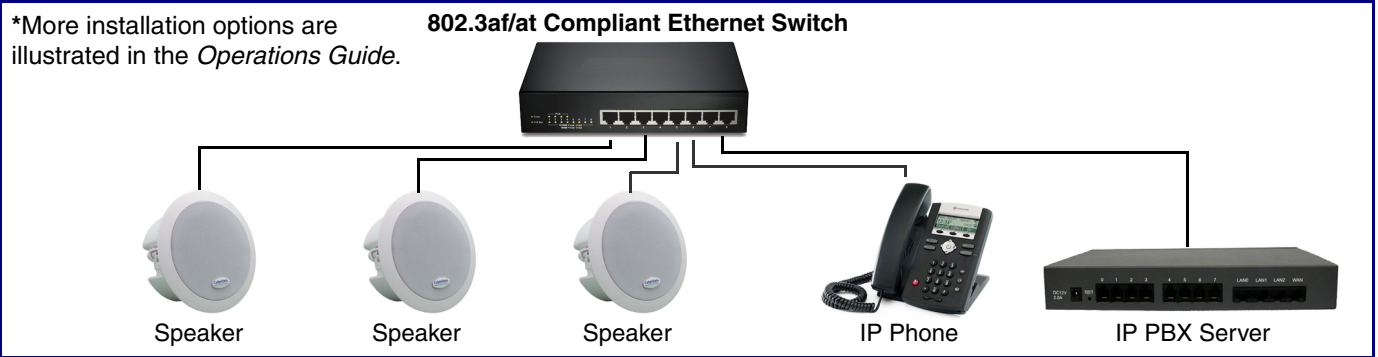

Getting Started

- Download the *Operations Guide* PDF file, from the **Downloads** tab at the following webpage:
<https://www.cyberdata.net/products/011458/>
- Create a plan for the locations of your speakers.
- **WARNING:** This product should be installed by a licensed electrician according to all local electrical and building codes.
- **WARNING:** To prevent injury, this apparatus must be securely attached to the floor/wall in accordance with the installation instructions.
- **WARNING:** The PoE connector is intended for intra-building connections only and does not route to the outside plant.
- **WARNING:** This enclosure is not rated for any AC voltages!

Parts

(1) Speaker Assembly



(1) Template for Speaker*



* See the last page of this document

Dimensions

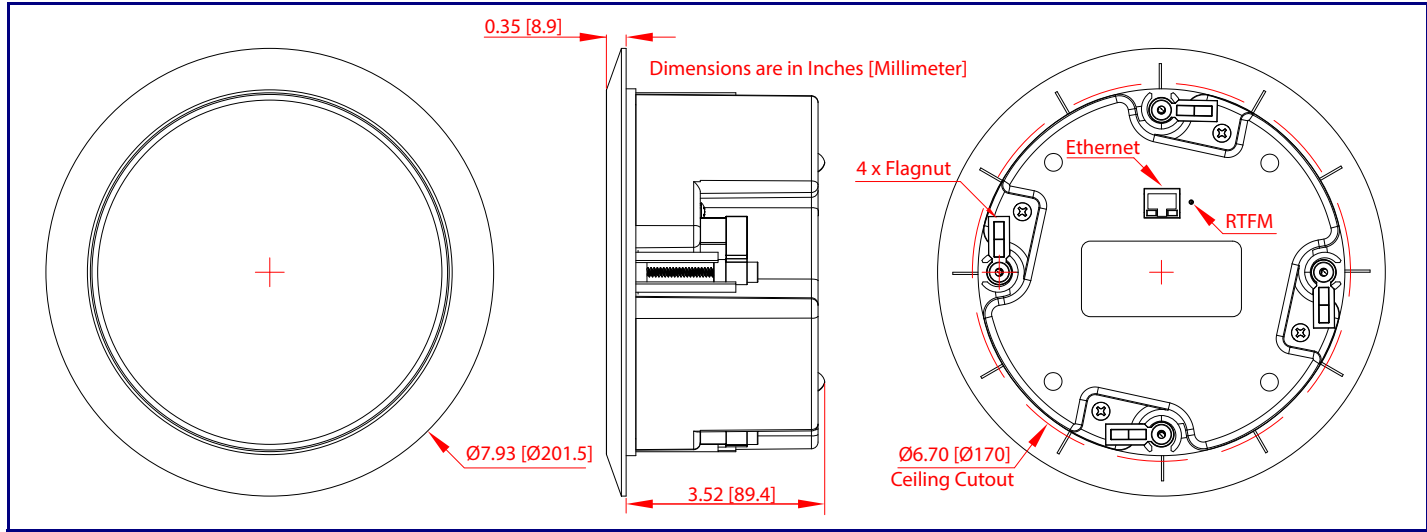

Features

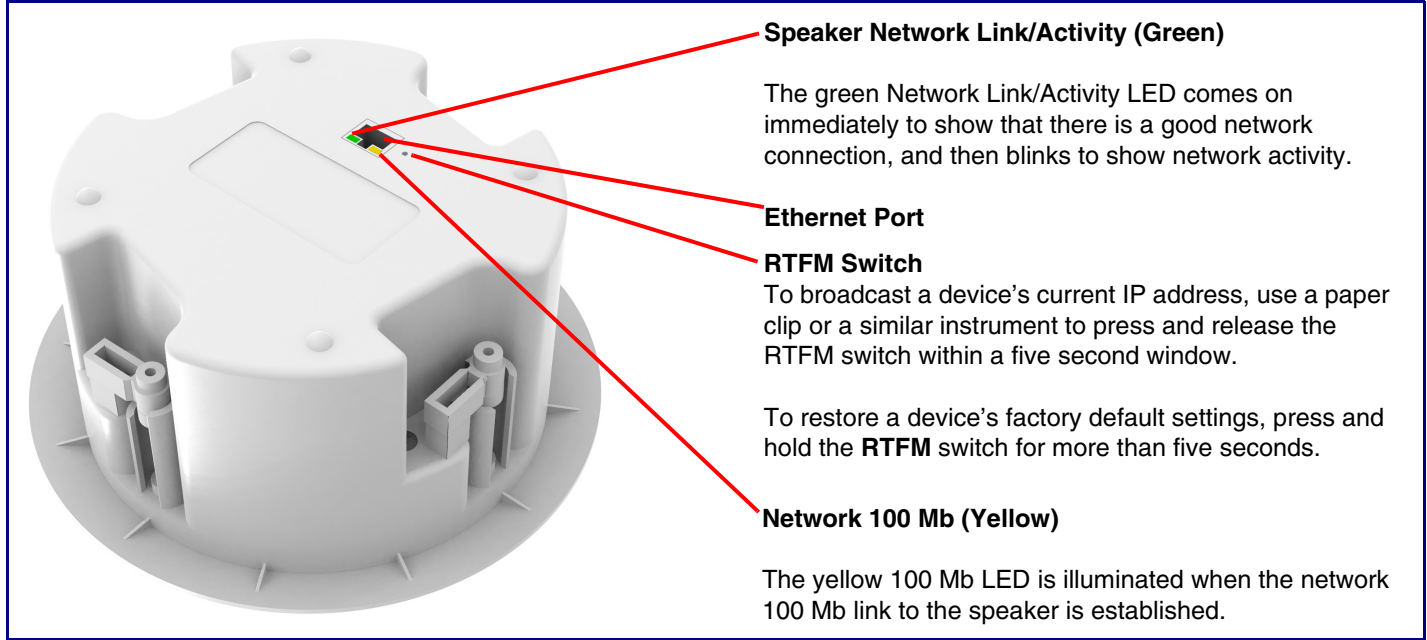

Connecting Power

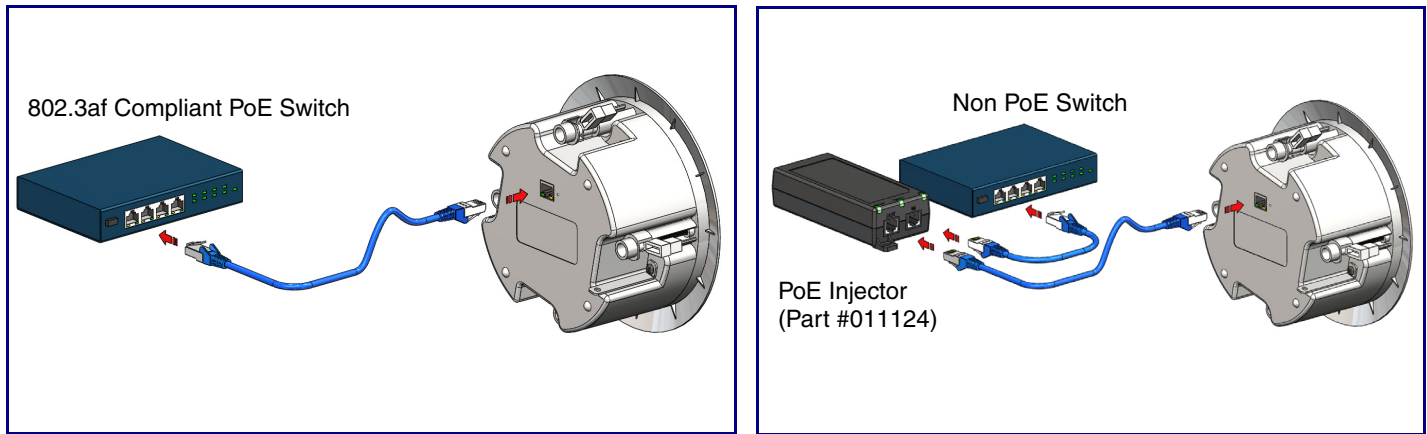

Mounting

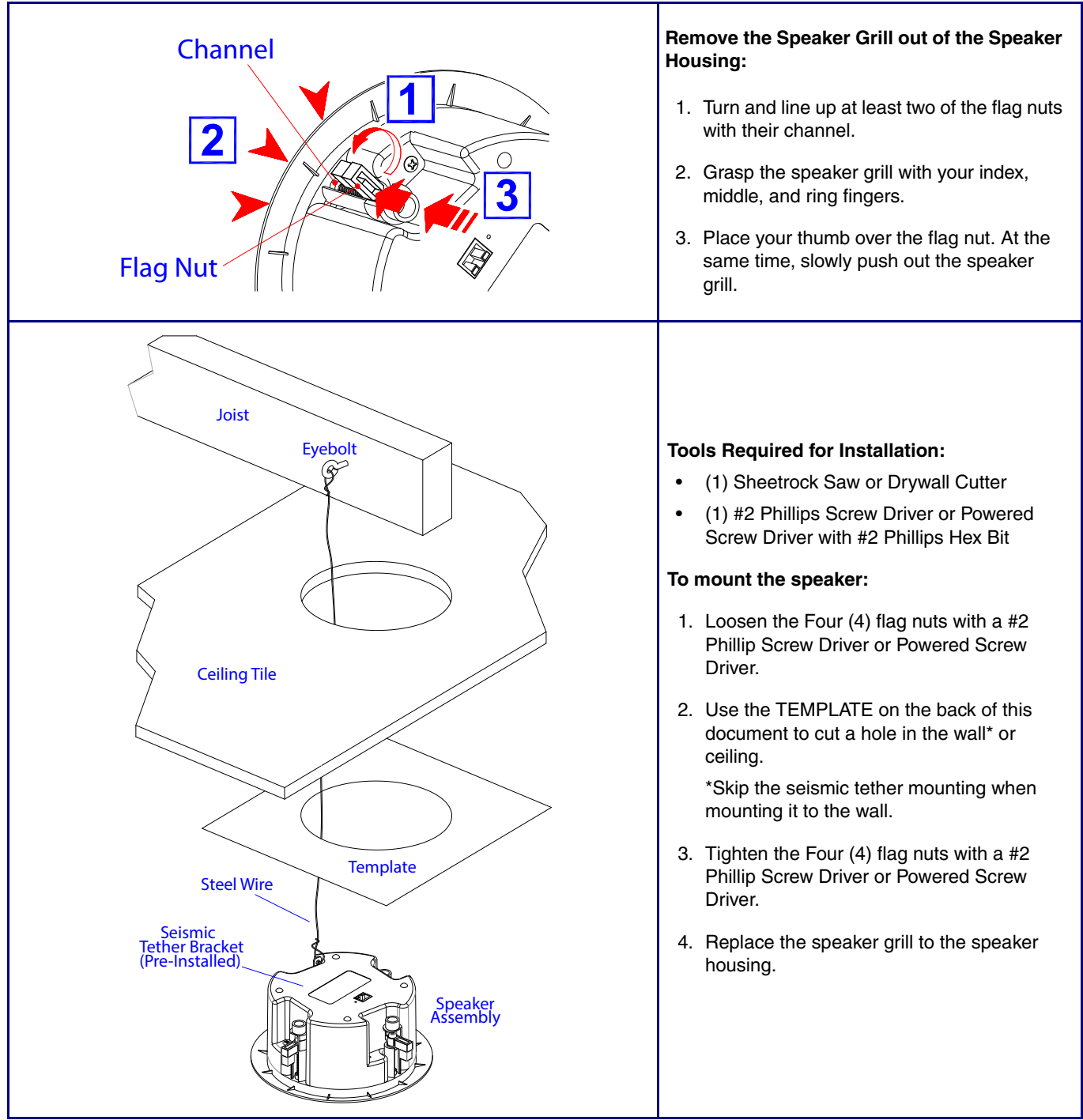

Contacting CyberData

Corporate Headquarters

CyberData Corporation
3 Justin Court
Monterey, CA 93940, USA
Phone: 831-373-2601
Fax: 831-373-4193
<https://www.cyberdata.net/>

Sales: 831-373-2601 ext. 334
Support: 831-373-2601 ext. 333
Support Website: <https://support.cyberdata.net/>
RMA Department Contact and Status: <https://support.cyberdata.net/>
Warranty Information: <https://support.cyberdata.net/>